

GlassCraft Entry Assembly

Instructions

Please note that these instructions are for the assembly (prehanging) of your door unit prior to installation, and should not be confused with field installation instructions. It is recommended that installation be performed by an experienced installer.

All surfaces of the door, sidelite, transom, and/or millwork (inclusive of all edges and surfaces milled for hardware) should be sealed prior to assembly. **If the unit has been ordered prefinished from GlassCraft, many of the steps outlined will not be necessary. Only the steps in bold type should be reviewed.**

TOOL LIST

- Caulking gun & exterior caulk
- Hammer
- Screwgun
- Screwdriver
- Finish nailer & 2" nails (optional)
- Pin nailer & 1" nails (optional)
- Stapler & 3/8" staples (optional)

Parts Code

(Note - Not all parts are in each entry. Code is marked on a label for each part.)

(H) Hinges	(T) T-Astragal
(HJ) Hinge Jamb	(F) Flush Bolt
(LJ) Leg Jamb	(SF) Sidelight Frame
(HD) Header	(SS) Sidelight Sill
(SW) Door Sweep	(GB) Glass Bead
(W) Weatherstripping	(TF) Transom Frame
(BM) Brickmoulding	(EM) Exterior Mull



Included with all door units are sufficient lengths of trim, including brickmould (bm) & interior casing (c). Units with sidelites and/or a transom also include lengths of exterior (em) and interior (im) mull. All trim is intentionally left long to allow for more flexibility in the field. It will be necessary to cut to length and/or mitre trim, as needed, before attaching to your assembled unit.

GLASSCRAFT
DOOR COMPANY

SINGLE DOOR (ASSEMBLY)

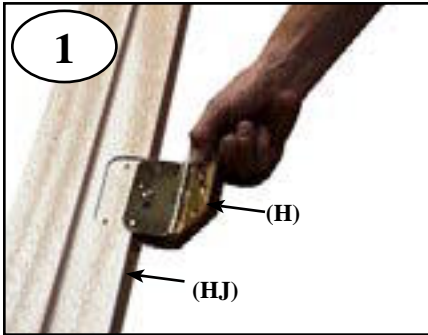

1. Attach hinges (h) to hinge jamb (hj) using 3/4" wood screws provided. Insure each hinge is fully seated in hinge pocket before securing with wood screws. **(Photos 1&2)**

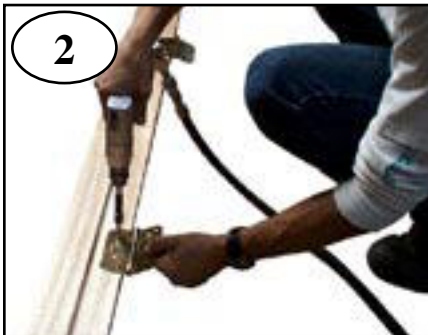

2. Caulk bottom of door with an exterior caulk and attach sweep (sw) with 1/2" weatherstripping nails (provided) or 3/8" staples (not provided), insuring each end of the sweep is flush with each edge of the door. **(Photo3)** Important note: rain fin should be facing exterior side of the door. (See drawing below)

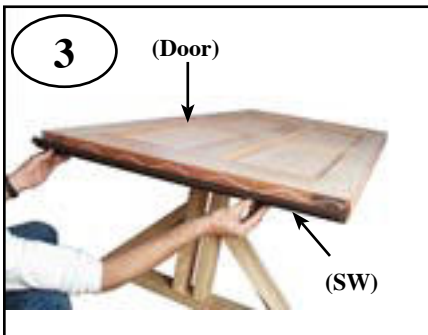

3. Attach hinge jamb (hj) to the door using 1" screws provided. Insure hinges are fully seated in hinge pocket. **(Photo 4)**

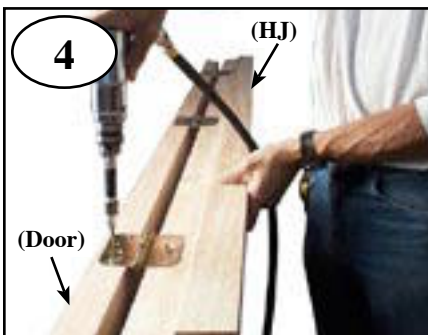

4. Apply exterior caulk to the dado (straight cut) at the top of each jamb leg (hj&lj) and on each side of header (hd). **(Photo 5)**

5. Attach header (hd) to each jamb leg (hj&lj) and fasten with 1-5/8" wood screws (provided). **(Photos 6&7)** Header and jamb legs are predrilled. The edges of the jamb legs and the header should line up and be even with each other. Screws should be tightened enough so there is no gap between the legs and the header.

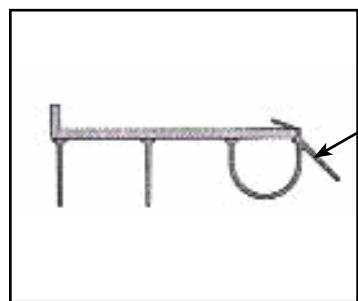

Rain Fin on sweep (sw) should face the exterior of the door

Door Sweep

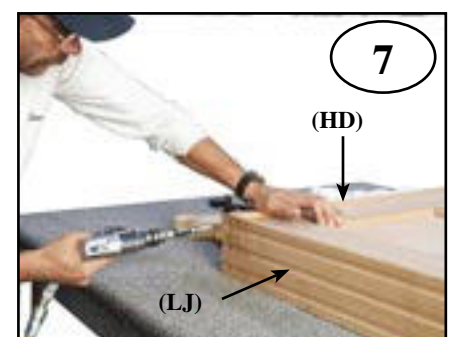
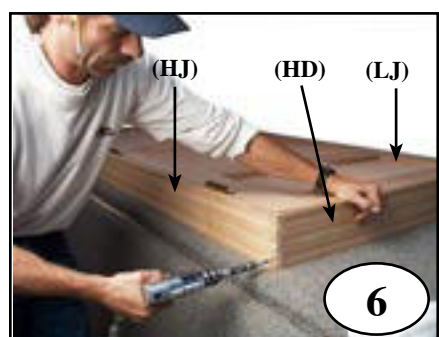



6. Caulk the surface of the sill dado (angled cut) that is facing down on each jamb leg. (hj&lj) (Photo 8)

Note: Sill comes with cover for protection. It is recommended that this be left on until door is ready for use.

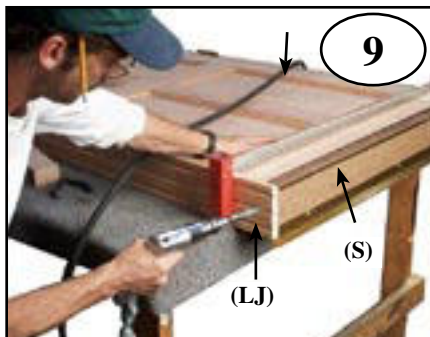

7. Apply sill (s) to the jamb legs (hj&lj) using 1-5/8" screws. (Photo 9) Sill gaskets have been preapplied to the sill to seal the gap between the jamb legs and the sill. Jamb legs and sill are predrilled with wood screws.

Swing door open to accomplish the following steps

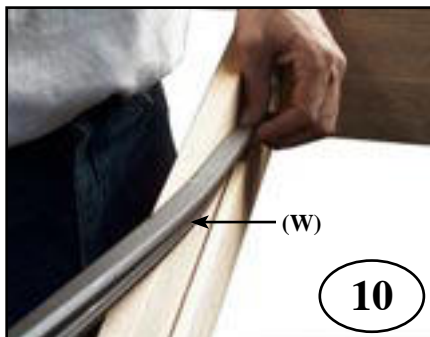

8. Insert weatherstripping (w) into the kerf in the header (hj) and jamb legs (hj&lj). (Photo 10) Run the weatherstripping the entire length of the kerf in the jamb legs all the way down to the top of the sill (Photo 11). Insert the weatherstripping the entire length of the kerf in the header so that it butts against the weatherstripping in the jamb legs.

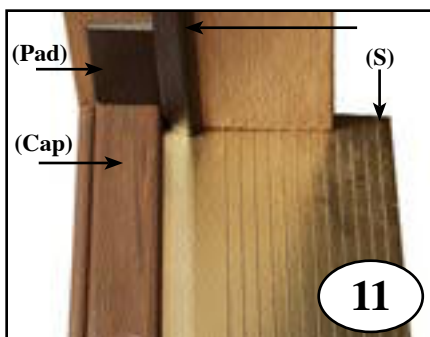

9. Attach adhesive-backed corner pads to both jamb legs. The thicker portion of the pad should be slipped behind the weatherstripping (w), and the bottom edge of the pad should rest on the cap (raised portion) of the sills. (Photo 11)

10. Close door.



Single door fully assembled with brickmould (unfinished)

DOUBLE DOOR (ASSEMBLY)

Please refer to single door assembly on previous pages for photos 1-6 and 8-11.



1. Attach hinges (h) to both hinge jambs (hj) using 3/4" wood screws provided. **(Photos 1&2)** Ensure each hinge is fully seated in hinge pocket before securing with wood screws.

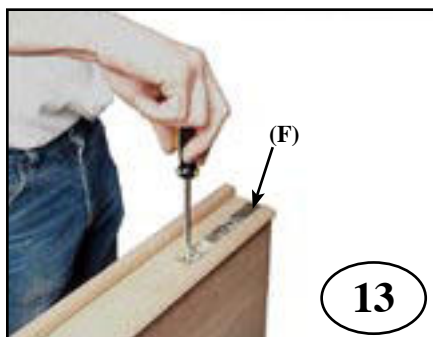

2. Attach t-astragal (t) to door that has been mortised on lock side to accept flush bolts (f) with 2" finish nails. **(Photo 12)** The t-astragal has been premachined for flushbolts and cut to length so that the ends of the t-astragal will be flush with the top and bottom edges of the door. Ensure that the thicker portion of the t-astragal fits flush against the exterior of the door and that the kerf is facing out away from edge of door.

3. Install flush bolts (f) at the head (top) and bottom (foot) of the t-astragal with screws provided in same pack with the flush bolt. **(Photo 13)** Note: there is a strike plate with 2 screws included in pack with flush bolts. Set these aside for now.

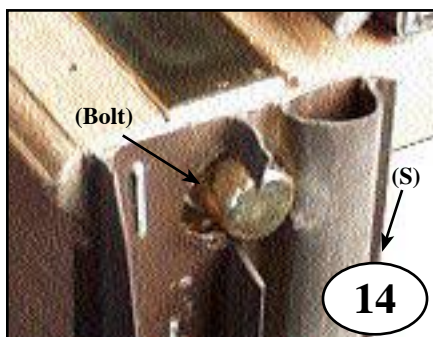

4. Caulk the bottom edge of each door with an exterior caulk and attach sweeps (sw) to each door using 1/2" weatherstripping nails or 3/8" staples. **(Photo 3)** Important note: rain fin should be facing exterior side of the door. (See drawing under single door assembly) One of the sweeps will have a 1/2" diameter hole predrilled at one end. **(Photo 14)** This sweep is attached to the door that has the t-astragal applied to it. The hole in the sweep is to allow room for the bolt to pass through it. Extend bolt and apply sweep so that end opposite of the end with the hole is flush with the edge of the door. Note: the end of the sweep with the hole will extend slightly past the surface of the t-astragal facing the opposite door.

This is normal. It is recommended that this not be trimmed back flush with the t-astragal, as this would create a path for air and water infiltration. The sweep for the other door is attached so that the ends of the sweep are flush with the edges of the door.

5. **Attach hinge jambs (hj) to each door using 1" wood screws provided. Ensure hinges are fully seated in hinge pockets. (Photo 4)**

6. **Apply exterior caulk to the dado (straight cut) at the top of each of the jamb legs (hj&lj) and on each side of the header (hd). (Photo 5)**



Double door fully assembled with brickmould (unfinished)

7. Attach header (hd) to hinge jamb legs (hj) and fasten using 1-5/8" wood screws. (Photo 6) Header and jamb legs are predrilled. The edges of the jamb legs and the header should line up and be even with each other. Screws should be tightened enough so there is no gap between the legs and header.

8. Caulk the surface of the sill dado (angled cut) that is facing down on each jamb leg. (Photo 8)

9. Apply sill (s) to hinge jambs (hj) using 1-5/8" screws (provided). (Photo 9) Sill gaskets have been preapplied to each end of the sill to seal the gap between the sill and the jamb legs. The sill and jamb legs are predrilled. Note: sill comes with cover for protection. it is recommended that this be left on until door unit is ready for use.

Swing doors open to accomplish the following steps

10. Insert weatherstripping (w) into the kerf in the header (hd), jamb legs (hj), and t-astragal(t). (Photo 10) Run the weatherstripping the entire length of the jamb legs and the t-astragal all the way down to the top of the sill. (Photo 11) Insert the weatherstripping the entire length of the header so that it butts up against the weatherstripping in the jamb legs.

11. Attach adhesive-backed corner pads to both jamb legs. The thicker edge of the pad should be slipped behind the weatherstripping and the bottom edge of the pad should rest on the cap (raised) portion of the sill (s) (Photo 11). Note: header and sill have been predrilled with holes to allow the door with the t-astragal to be locked into place.

12. Install strike plate (refer to step 3 above) in the mortised portion of the header and fasten with screws provided. (Photo 15).

13. Close door with t-astragal (insure flush bolts are not extended while closing door) and extend flush bolts into holes in header and sill.

14. Close other door.

SIDELIGHT (ASSEMBLY AND ATTACHMENT)

Sidelite frames (sf) have been pre-assembled.

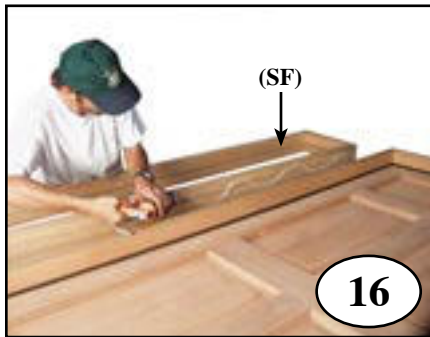

1. Run a heavy bead of exterior caulk along the back of the sidelite frame surface that will be attached to the assembled single or double door unit. (Photo 16)



2. Attach the assembled sidelite frame (sf) frame to the assembled single or double door unit using 1-1/4" wood screws provided. (Photo 17) Pilot holes have been predrilled. Insure that the top of the sidelite frame is flush with the top of the door unit.



3. Apply a bead of caulk along the inside rabbeted corner the entire length of each leg and header of the sidelite frame to seal the joint between the sidelite and the sidelite frame. (Photo 18)

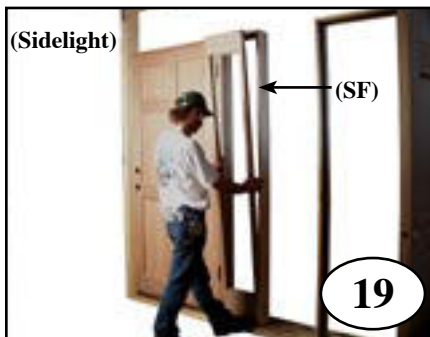

4. Place sidelite in the sidelite frame (sf) (Photo 19) so that sidelite rests firmly on the cap of the sidelite sill (ss). (Photo 20) Note: for illustration purposes, one side of the sidelite frame has been removed

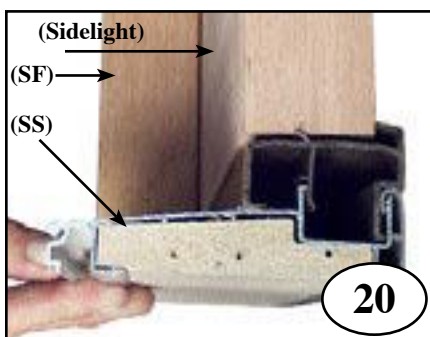

5. Secure sidelite in frame using precut pieces of glass bead (gb) provided. The glass bead should be placed at the junction of the sidelite and the frame with the flat surface of the bead resting on the sidelite and the lip of the bead extending away from the frame. Nail through bead into frame with 1" nails. (Photo 21)

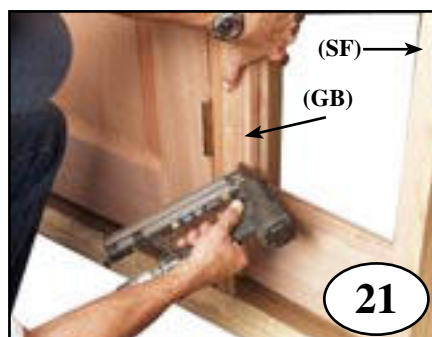

6. Repeat for other side if your unit has two sidelights.

Door with sidelights fully assembled with brickmould (unfinished)



TRANSOM (ASSEMBLY AND ATTACHMENT)

Note: It is recommended that the attachment of the transom frame to the door unit be done after unit is installed in opening. Transom frames (tf) have been preassembled.



Direct Set

1. Run a heavy bead of exterior caulk on top of the header of the completed door unit. (Photo 22)

2. Attach transom frame (tf) to top of unit with 1-1/4" screws . Pilot holes have been predrilled. (Photo 23)

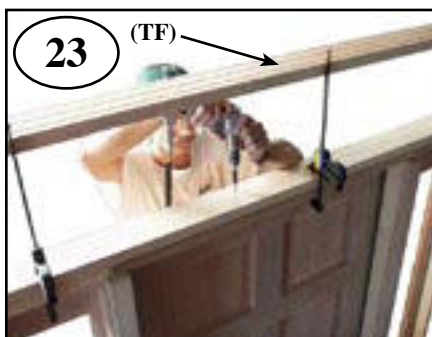

Sash Set

1. Run a heavy bead of exterior caulk on top of the header of the completed door unit. (Photo 22)

2. Attach transom frame (tf) to top of unit with 1" screws provided. Pilot holes have been predrilled. (Photo 23)

3. Apply a bead of caulk along the inside rabbeted corner the entire length of both side frames and the head and bottom frame. (Photo 24)



4. Place sash (ts) in transom frame (tf). (Photo 25) Secure using precut pieces of glass bead (gb) provided. The glass bead should be placed at the junction of the sash and frame with the flat surface of the bead resting on the sash and the lip of the bead extending away from the frame. Nail through bead into frame with 1" nails (Photo 26)

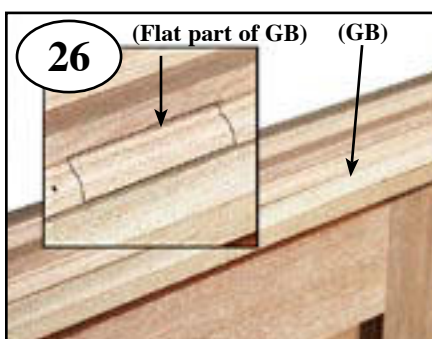
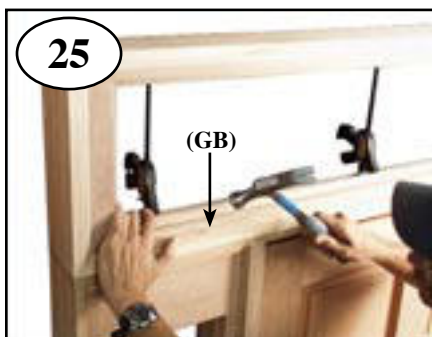

Door with sidelights with transom fully assembled with brickmould (unfinished)

